

Access Point Module

This assembly consists of a Titan Controller Board connected to a Controller Master Backplane mounted in a white powder-coated aluminum enclosure. An I/O Power Supply, power transformer, back-up 12V battery, auto-dialer and USB Back-up Module are also included.



www.arguscontrols.com

Applications

Each Titan system starts with an Access Point module located near and connected to the Argus Server PC used for operator access. The Access Point is equipped with a Titan controller and components to facilitate Ethernet connection to the Operator PC, external alarm output relays, an included automatic alarm dialer, a battery for emergency backup power, and power supply circuitry for operating the controller and the first segment of the connected **I/O Communications Network** (see the control system illustration on the back page).

The Access Point features all the control capabilities of a standard Titan controller, and on smaller installations, may be the only controller required. Additional controllers are added via Argus System Network Communications cabling or Ethernet connection.



Alternatives

Additional controllers on the Titan system use a **Basic Controller** configuration. This consists of a Titan Controller on a standard Back Plane with a plate to facilitate mounting into Argus panels (part number: **TC-BC/RCP**). A complete controller assembly mounted in a separate enclosure (part number **TC-BC/C**) is also available. Basic Controllers do not have alarm contacts, or battery charging circuitry.

Features

- **Easy Connection to the PC** – the Access Point controller includes a fast Ethernet connection to the Argus Server PC.
- **Battery Backup and Smart Charging circuitry** – a 12-volt battery provides emergency power for alarm annunciation and external communications with the access point during power outages.
- **Alarm Outputs** – the controller back plane is equipped with four alarm outputs used to provide alarm signals to external annunciation devices such as sirens, lights, or alarm dialers.
- Refer to Data Sheet: **TC-BC/RCP** for Titan Controller specifications.

Access Point Specifications

Enclosure	Argus part: SUB-CL100/NBP UL type 12, white powder coated aluminum
Enclosure Dimensions	22" x 18" x 4" (H x W x D)
Titan Controller	Argus part: TTN-CONT-2.0C/B (includes Ethernet adapter daughter board) See Controller Specifications below.
Controller Back Plane	Argus part: TTN-CMBP
Power Supply	Argus part: TC-IOPS/RCP (Titan I/O Network Power supply)
Battery	Argus part: TTN-CONT/BBU 12 Volt, 7.2 Amp-Hour sealed lead-acid.
Line Voltage Transformer and Fused Terminal Block	Argus part: RCC-TX75/TITAN Input voltage: 120 VAC (line voltage wiring must be supplied to the panel) Output Voltage: 24 VAC, 75 VA
Alarm Autodialer	Argus part: TTN-AD2001 automatic voice pager/dialer
Controller System Network and I/O Network Cable	Argus part number CAB- 2C18G/TITAN (West Penn Wire - AQ224): a 2-conductor 18AWG UV and moisture resistant cable suitable for indoor/outdoor use and is direct burial and wire tray-rated. NO SUBSTITUTIONS – USE OF THIS EXACT WIRE IS CRITICAL FOR PROPER NETWORK COMMUNICATION Note: Controllers can also be connected via CAT5 Ethernet pathways. The I/O Device Network must use the Aquaseal AQ224 Cable.

Titan Controller Specifications

Dimensions	8.5" x 8.5" x 1" (length x width x height)
Power Consumption	3.75 Watts @ 24VDC (via Titan I/O Power Supply)
Data Storage Memory Backup Power	Lithium battery will hold up memory for approximately 2 years without power (settings are automatically reloaded on power-up)
Program Execution	All programs are executed once each second
Maximum linked controllers per system	64 (more if domain bridging is used)
Program Capacity	Up to 255
Program Storage Memory	4 MB (Flash) + 1 MB (Fast RAM)
Data Storage Memory	1 MB (RAM)
Removable Memory	SD Card Slot (a 4 GB SD card is included)
Power and Data Connections	All connections except Ethernet are provided via the included backplane

Titan System Schematic

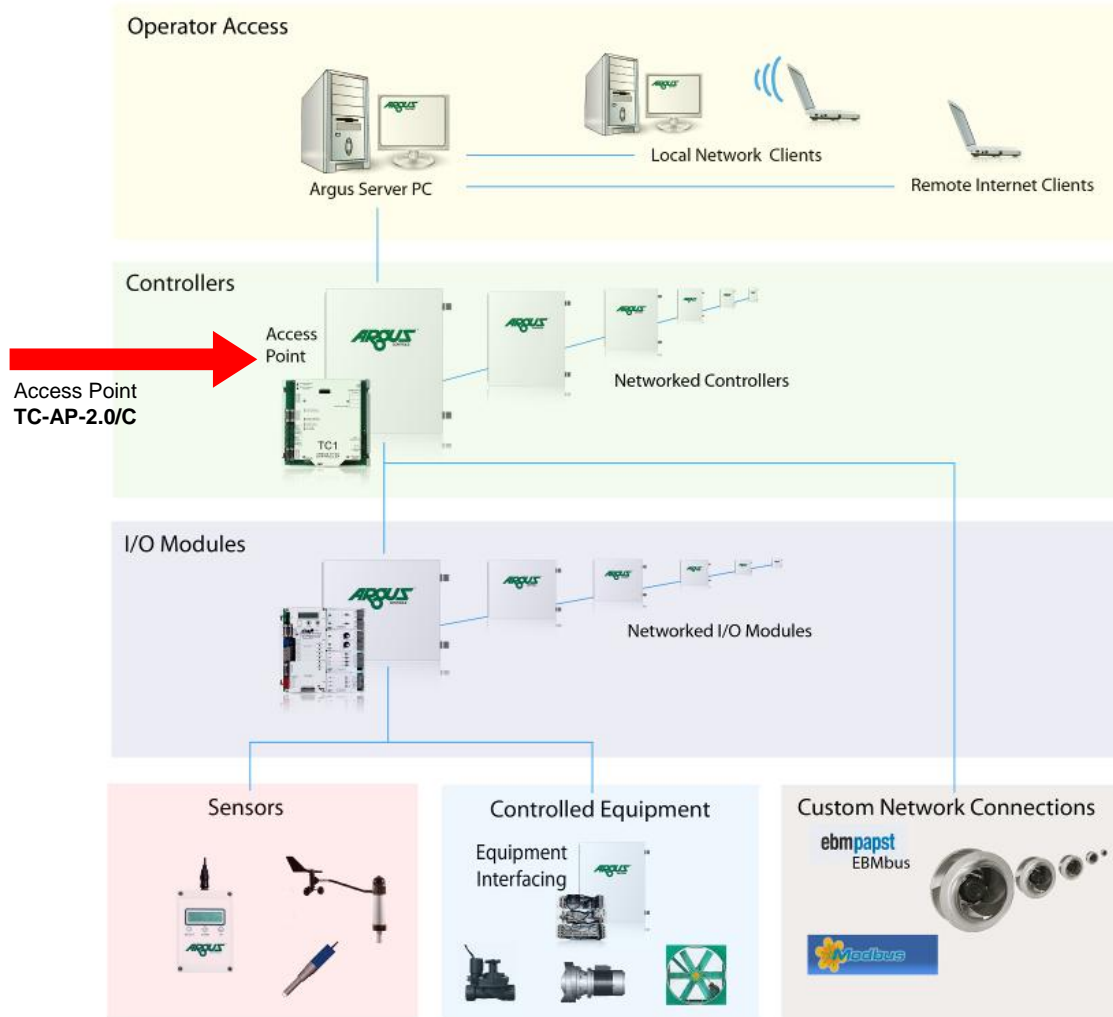

Notes:

Additional controllers and I/O equipment are provided in either separate enclosures or they may be ganged together in panels. Argus UL certified panels are built to order, and can also include line voltage interfacing and power distribution as required.

Additional Information

Additional information is available on the data sheets for the component parts. For more information, please contact Argus.



www.arguscontrols.com